

# SMI11-2 Microbiological Incubator



Model Name / Order Part ID	SMI11-2/SLM1122-E
Capacity	10.9 cu.ft. (309 liters)
Interior Dimensions (W x D x H)	36.2" x 20.0" x 26.0" 920 x 508 x 660 mm
Exterior Dimensions (W x D x H)	42.0" x 27.0" x 38.0" 1067 x 686 x 965 mm
Unit Weight	195 lb (88.5 kg)
Shipping Weight	300 lb (136 kg)
Shelves	6 standard, 12 maximum
Maximum Weight Per Shelf	35 lb (15.9 kg)
Permitted Total Load	210 lb (95.3 kg)
Standard Door Gasket	Vinyl
Access Port	1
Controls	Digital
Warranty	2 Year Warranty
Interior Construction	430 Stainless Steel
Exterior Construction	Painted Cold Roll Steel
Vertical Clearance	2" (51 mm)
Wall Clearance, Each Side	4" (102 mm)
Wall Clearance, Rear	4" (102 mm)

## Electrical

Electrical Supply /Hz, AC, 1Ø	50/60 Hz, 220-240 AC, 5.0 Amps
Nominal Power (watts @ 37°C)	288 watts
Plug Supplied	EU1-16P
Energy Consumption (kWh/day) - At 37°C	5.3

## Temperature Range Ambient +8°C to 70°C

Recovery after Door Opening (30 sec.) - Minutes to 37°C	5.5
Recovery after Door Opening (60 sec.) - Minutes to 37°C	7.0

## Temperature Uniformity

At 37°C	0.5
---------	-----



Learn More About Sheldon Manufacturing  
[sales@sheldonmfg.com](mailto:sales@sheldonmfg.com)  
[sheldonmanufacturing.com](http://sheldonmanufacturing.com)  
 (503) 640-3000



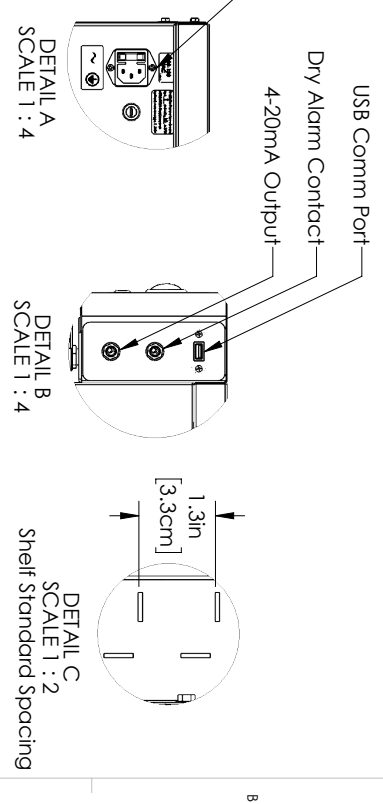
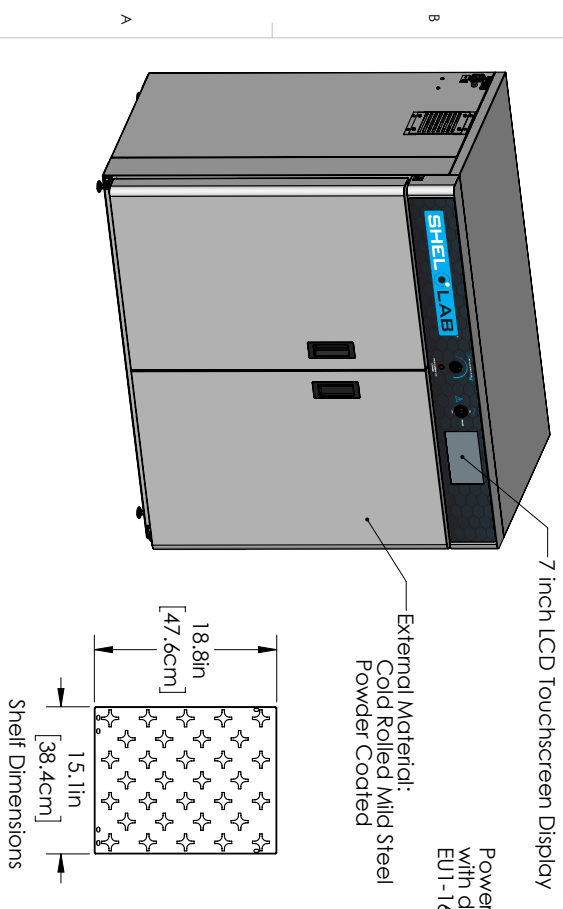
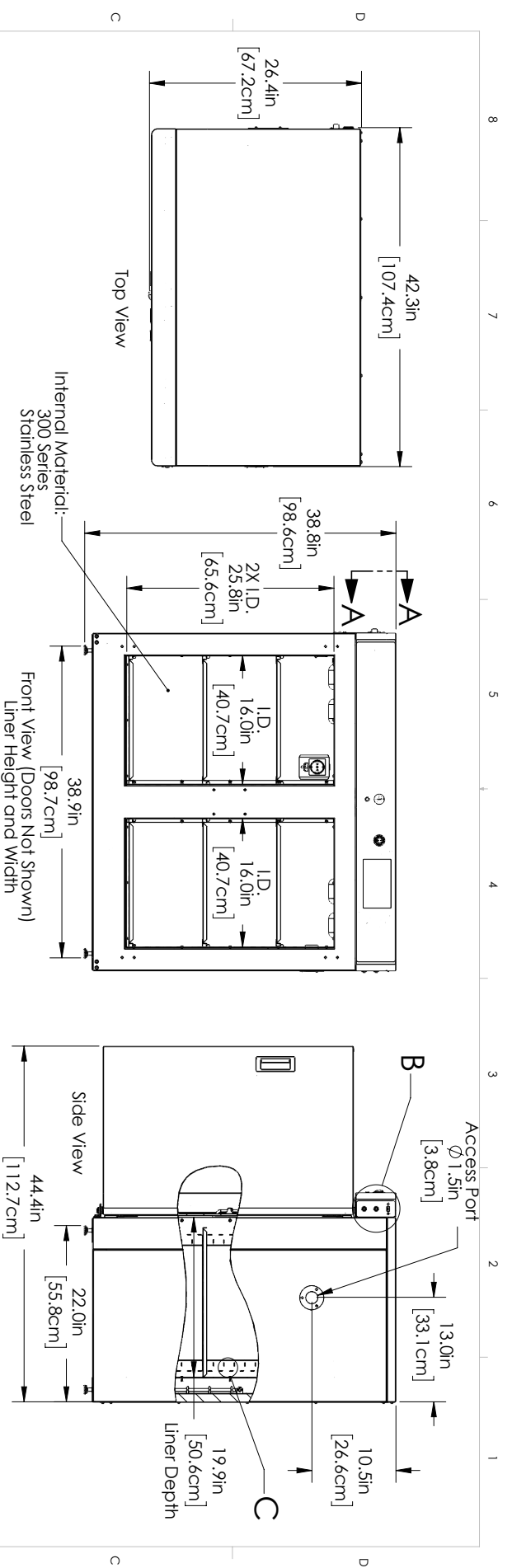

		NAME	DATE	MODEL:
		TGR	4/4/2018	SM111-2 INC 11CF DRY 220-240V SL
Sheldon Manufacturing, Inc 300 N 26th Ave Corvallis, OR 97113 www.shellab.com		PROPRIETARY AND CONFIDENTIAL THE INFORMATION CONTAINED IN THIS DRAWING IS THE SOLE PROPERTY OF SHELDON MANUFACTURING, INC. AND IS TO BE USED ONLY IN CONNECTION WITH THE PART OR AS A WHOLE WITHOUT THE WRITTEN PERMISSION OF SHELDON MFG. COMPANY (REVISED)		
SIZE	DWG. NO.	REV		
<b>B</b>	9121281			
SCALE: 1:12	WEIGHT:	SHEET 1 OF 1		